



Model: D100

VALVE ACCESSORIES & CONTROLS DIGITAL VALVE POSITIONER

A new generation of electro-pneumatic positioners for use with pneumatic rotary actuators in industrial environments.

This versatile micro-processor based positioner controls the rotary angle of a pneumatic actuator in proportion to the input current (typically 4 - 20 mA)

Owing to the positioners reliability in high vibration critical applications, combined with its simple calibration and minimal air consumption, the unit is ideally suited where robustness and price are key factors.

The positioner is powered from a 24Vdc supply and is reverse polarity and over-voltage protected. A visual indicator is available as an option.



Input Signal

4 to 20 mA (adjustable between 3 and 22 mA)

Power Supply

24 Vdc (option 12 Vdc)

Supply Pressure

< 700Kpa (100 psi)

Linearity Error

<2% FS

Repeatability

<1% FS

Air Capacity

24 L/min maximum (0.8 SCFM)

5 L/min typical (0.18 SCFM)

Bleed Rate

0 L/min (0 SCFM)

Temperature Range

-4 to +50 Celsius (24 to +122 Fahrenheit)

Simple calibration. Self calibration will cycle the valve and actuator twice before the assembly is ready for operation. Manual override, calibration and programming is done via a single pushbutton. Commands are entered by pressing the button the corresponding number of times.

1	Run (Start positioning)
2	Calibrate
3	CW or CCW operation
4	Fail CW or CCW on loss of signal
5	Fail in position on loss of signal
6	Set angle of rotation
7	Set signal range

Connections

Air connections 6mm OD tube

Electrical entry M20

Ingress Protection

IP65

Surface Finish

Powder Polyester coated lid

Black Anodised base plate

Weight

1.1Kg (2.4lbs)

Actuator Interface

50mm PCD according to NAMUR

Vibration

Excellent resistance to pump and similar vibrations

Options

Visual indicator

VDE/VDI 3845 mounting bracket

Power - The positioner requires a separate 24 Vdc supply.

Protection - The microprocessor forms the heart of the positioner and is located within a high strength enclosure to protect it from damage. The enclosure is made of aluminium alloy and has been independently tested for an impact strength of 7 joules (without indicator) The cast lid is sealed using a gasket to provide protection to IP65.

Visual Indication - For installations where it is necessary for the valve position to be observed in operation an optional visual indicator can be specified. This made up of a black and white 'dome' indicator under a clear polycarbonate window.

Dimensions

Model : D100

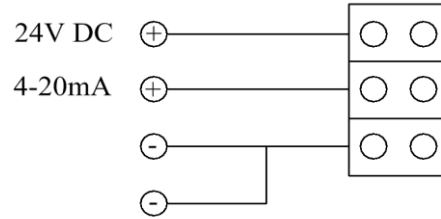
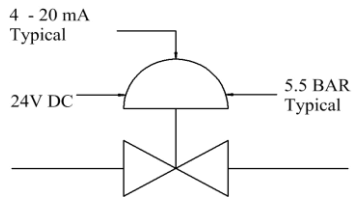
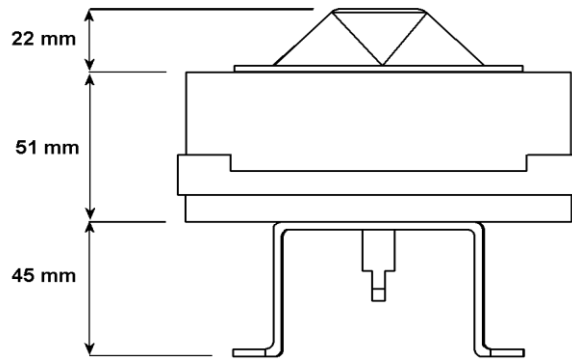
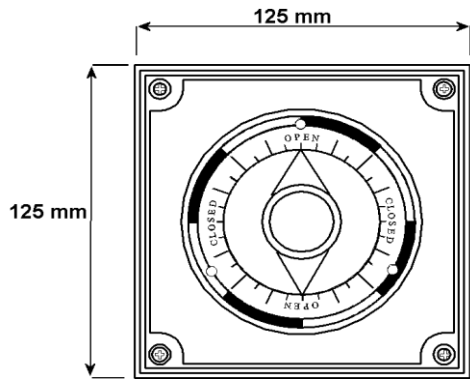

Note: common negative

Ordering codes

Positioner	Actuator	Action	Fail Mode	Indicator	Characteristic
D100	-	-	-	-	-
Spring return	S				
Double acting	D				
Increasing signal ClockWise		CW			
Increasing signal Counter Clockwise		CC			
		ClockWise	CW		
		Counter Clockwise	CC		
		Fail Freeze	FF		
			None	0	
			Dome	1	
				Linear	L